

WASILLA CENTER PHASE 3

705 S. KNIK-GOOSE BAY ROAD
WASILLA, ALASKA

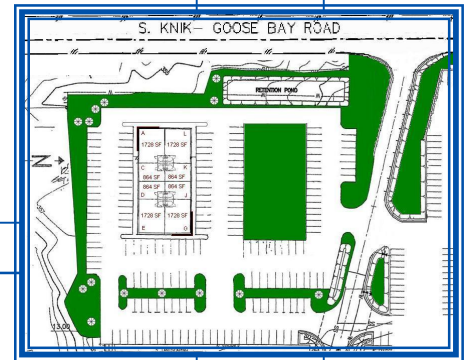

- New Construction - Available Fall 2011
- Up to 10,368 sq. ft.
- Excellent Exposure
- Individual end units as small as 1,728 sq. ft. (48'x 36')
- Middle units as small as 864 sq. ft. (24'x36')
- KGB end side spaces having the potential for drive through windows
- Vanilla shell completion (Paint, carpet, ADA bath, HVAC)
- Modern Aesthetic look with abundant windows
- Rates range between \$1.60 to \$1.80 (depending upon exposure) plus gas

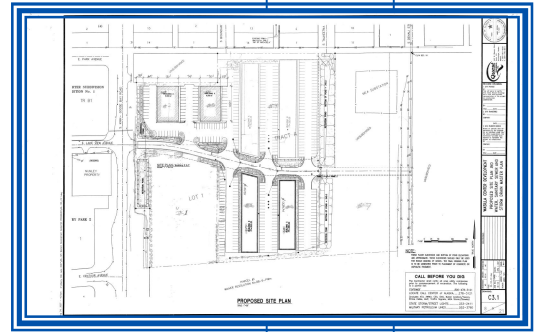

THIS PROPERTY IS PROFESSIONALLY MANAGED BY
WESTERN ENTERPRISES

LOCATED AT

4101 ARCTIC BLVD., SUITE 203
ANCHORAGE, AK 99503

(907) 562-2244



FOR OTHER AVAILABLE PROPERTIES AND COMPANY INFORMATION
PLEASE VISIT www.LEASEALASKA.COM